

# RANTALAN RANTA-ASEMAKAAVA

Vuohijärvi

Hautalahti

Lepistaranniemi

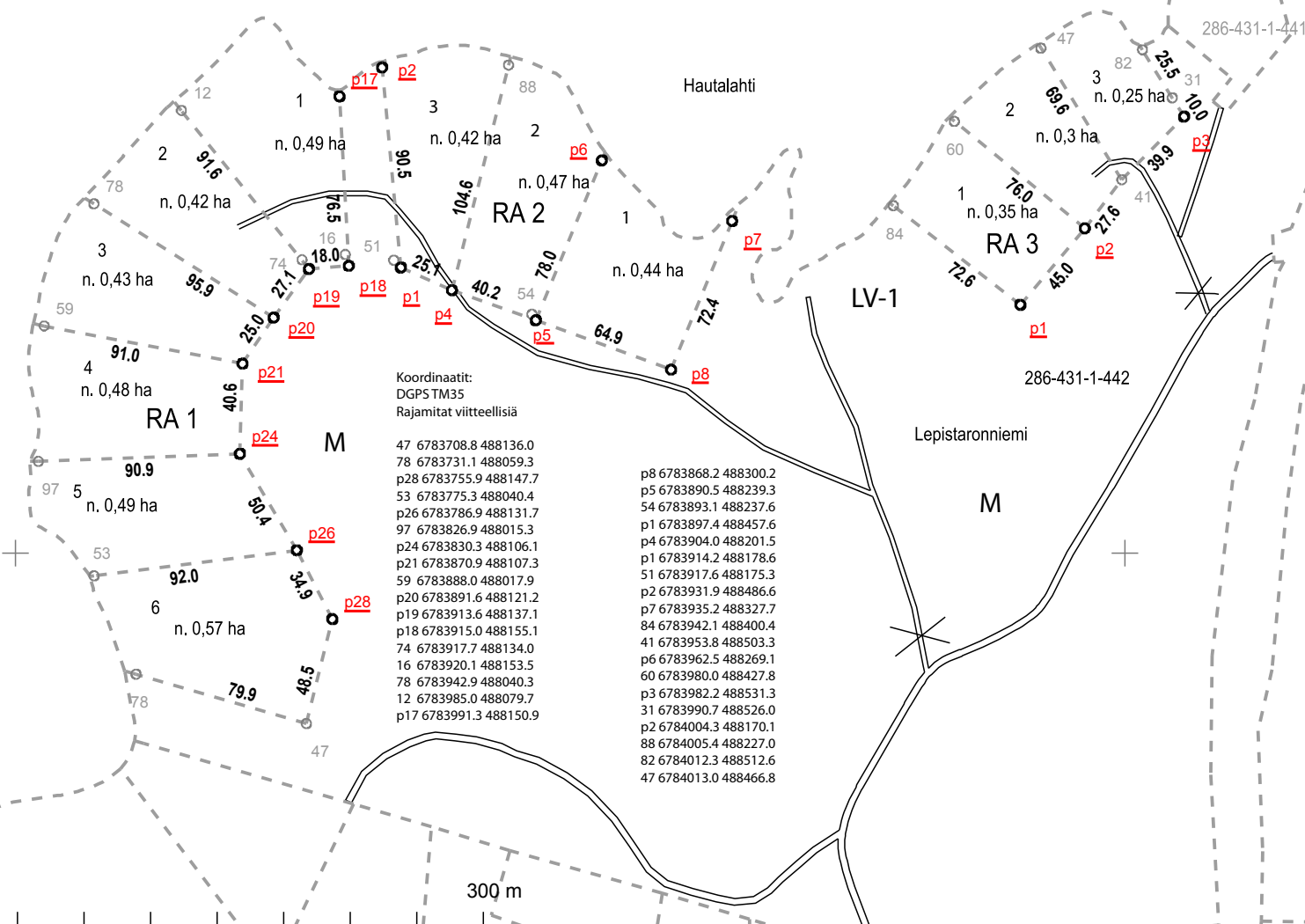

Koordinaatit:  
DGPS TM35  
Rajamitat viitteellisiä

47 6783708.8 488136.0  
78 6783731.1 488059.3  
p28 6783755.9 488147.7  
53 6783775.3 488040.4  
p26 6783786.9 488131.7  
97 6783826.9 488015.3  
p24 6783830.3 488106.1  
p21 6783870.9 488107.3  
59 6783888.0 488017.9  
p20 6783891.6 488121.2  
p19 6783913.6 488137.1  
p18 6783915.0 488155.1  
74 6783917.7 488134.0  
16 6783920.1 488153.5  
78 6783942.9 488040.3  
12 6783985.0 488079.7  
p17 6783991.3 488150.9

p8 6783868.2 488300.2  
p5 6783890.5 488239.3  
54 6783893.1 488237.6  
p1 6783897.4 488457.6  
p4 6783904.0 488201.5  
p1 6783914.2 488178.6  
51 6783917.6 488175.3  
p2 6783931.9 488486.6  
p7 6783935.2 488327.7  
84 6783942.1 488400.4  
41 6783953.8 488503.3  
p6 6783962.5 488269.1  
60 6783980.0 488427.8  
p3 6783982.2 488531.3  
31 6783990.7 488526.0  
p2 6784004.3 488170.1  
88 6784005.4 488227.0  
82 6784012.3 488512.6  
47 6784013.0 488466.8



MK 1:3-000